

PRODUCT SPECIFICATION SHEET



Rev. C3

LP3 LED Paver



Large LED paver fitting. Available in either stainless steel or hard anodised aluminum.

Comprising of a flush bezel of 47mm (1.85") in diameter and a recess depth of 38.5mm (1.5"), the aluminum fitting is available in a range of finishes and colors.

This paver features an internal lens that can be used to focus the light on areas and objects requiring accentuating. It comes with a recessed dark cone that reduces glare, making it a suitable choice for installation in areas where human footfall is commonplace, such as pathways and stairwells.

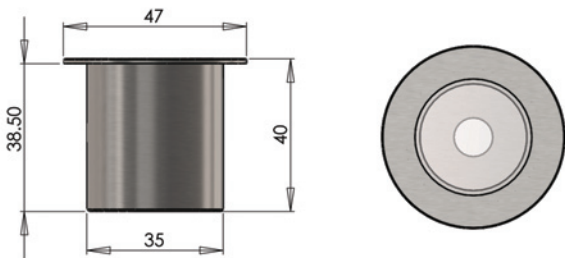

Note that all dimensions are shown in mm



TECHNICAL INFORMATION

Illuminator	LED
Operating Environment	Outdoor
Material	Stainless steel or hard anodised aluminum
Finishes	Hard Anodised: black, silver, custom RAL Stainless Steel: natural
Mounting Hole Size	36mm (1.4")
Power Consumption	1W per fitting
Voltage	3.2V nominal
Color Temp. & CRI	3000K - 96CRI (typical) / 4000K - 95CRI (typical)
Typical Luminous Flux (based on 15° lens)	3000K: 84lm/W / 4000K: 88lm/W
Lens Options	15° / 51°

DRIVER CONTROL OPTIONS (Depending on specified driver)

No Dimming	Local Potentiometer Dimming
0-10V Dimming	Remote Potentiometer Dimming

PRODUCT CODES

MODEL	OPTICS	COLOR TEMP	MATERIAL	FINISH				
UFO LP3	15°	15	3000K	30	Stainless Steel	SS	Black	BL
	51°	51	4000K	40	Hard Anodised	HA	Silver	SV
							No color	NC
							Custom	CU



e.g. UFO LP3-15-30-SS-BL

