

PRODUCT SPECIFICATION SHEET

LP5 LED Paver



Rev. C3



Small LED paver fitting. Available in either stainless steel or hard anodised aluminum.

At just 34mm (1.33") in diameter and 27mm (1.0") in length, the LP5 packs a punch as the smallest of all our pavers. Its compact stature means that the fitting can be installed in the shallowest of recesses or when space is at a premium.

Available with a choice of color temperatures and narrow or wide optics that allow you to direct the light where it is needed most. Dimming functionality is also supported using a UFO approved dimmer.

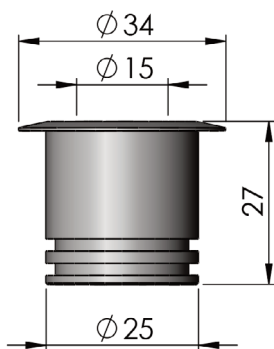

Note that all dimensions are shown in mm



TECHNICAL INFORMATION

Illuminator	LED
Operating Environment	Outdoor
Material	Stainless steel or hard anodised aluminum
Finishes	Black, silver, custom RAL to order
Mounting Hole Size	29mm (1.15")
Power Consumption	1W per fitting
Voltage	3.2V nominal
Color Temp. & CRI	3000K - 95CRI (typical) / 4000K - 95CRI (typical)
Typical Luminous Flux (based on 15° lens)	3000K: 83lm/W / 4000K: 89lm/W
Lens Options	15° / 51°

DRIVER CONTROL OPTIONS (Depending on specified driver)

No Dimming	Local Potentiometer Dimming
0-10V Dimming	Remote Potentiometer Dimming

PRODUCT CODES

MODEL	OPTICS	COLOR TEMP	MATERIAL	FINISH
UFO LP5	15° 15	3000K 30	Stainless Steel SS	Black BL
	51° 51	4000K 40	Hard Anodised HA	Silver SV
				No color NC
				Custom CU

UFO LP5
e.g, UFO LP5-15-30-SS-BL

