

# LM3 LED FITTING ACCESSORY GUIDE

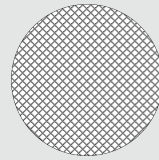

The LM3 fitting can be specified with 2 different LED module options. Variants fitted with the XIM modules can take 1 accessory while those fitted with XTM modules can be fitted with 2 accessories.

## Accessory Types



Honeycomb

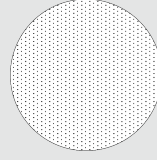

Diffuser Lens

## Circlip



The circlip can be removed with fingers or pliers to allow insertion of accessories.

## XIM Module Accessory Installation

Unscrew the front snoot and remove.

The accessory slots are positioned at the top of the snoot, just under the front glass.

Remove the circlip from under the accessory slot.

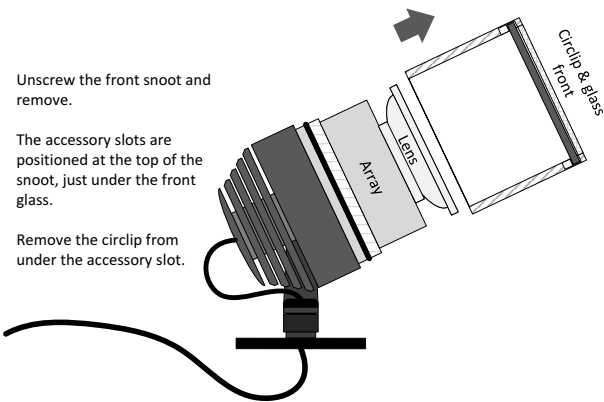

Variants with XIM LED modules can take one accessory.

Drop the accessory and lens into the snoot so they sit on the glass front.

Do not re-insert the circlip.

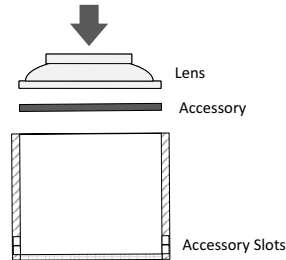

Push the snoot assembly onto the body of the fitting until it just covers the o'ring and then screw it on for the last 6mm to ensure a tight fit.

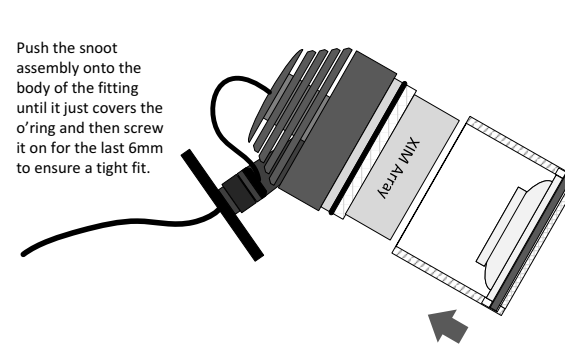

The fitting is now ready for use.

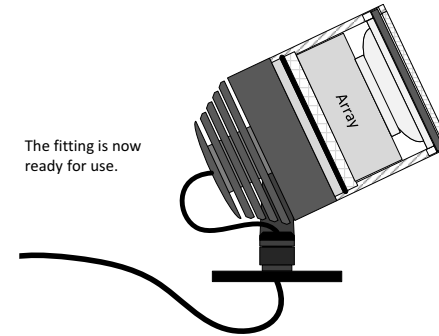

## XTM Module Accessory Installation

Unscrew the front snoot and remove.

The accessory slots are positioned at the top of the snoot, just under the front glass.

Remove the circlip from under the accessory slot.

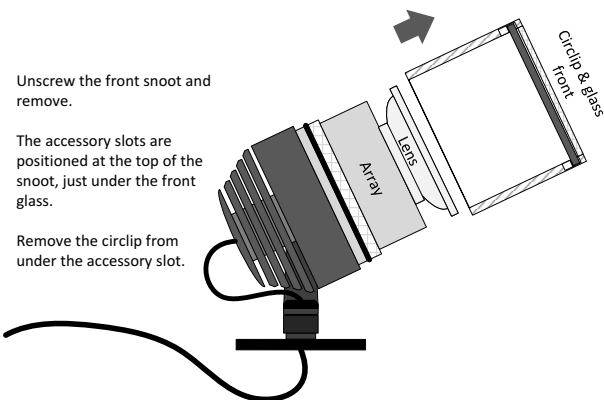

Variants with XTM LED modules can take one or two accessories.

Drop the accessories and lens into the snoot so they sit on the glass front.

If using only one accessory, insert the circlip behind it. Otherwise do not re-insert the circlip.

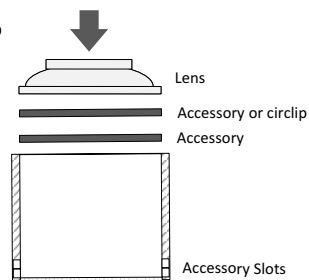

Push the snoot assembly onto the body of the fitting until it just covers the o'ring and then screw it on for the last 6mm to ensure a tight fit.

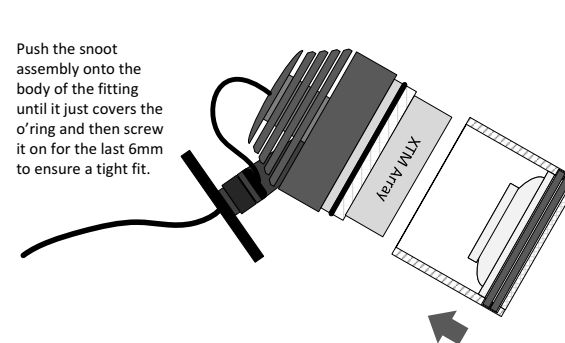

The fitting is now ready for use.

